

KIA Genuine Accessories

Kit Overview

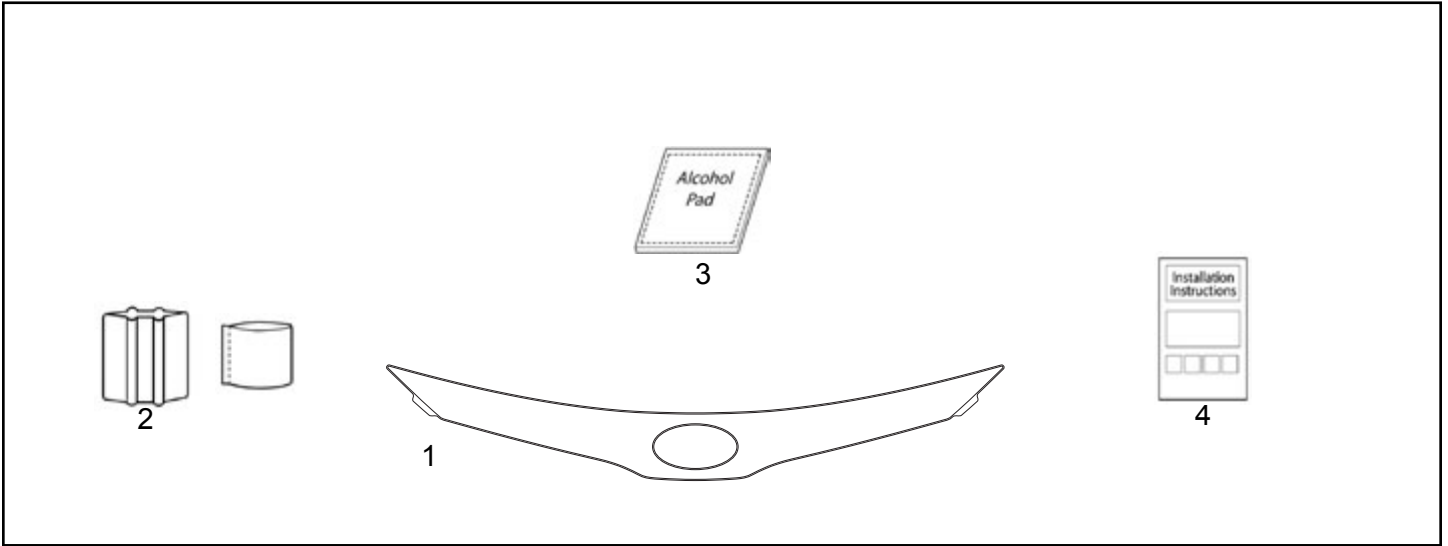

No.	Qty.	Description
1	1	Protective Film
2	1	Squeegee with Sleeve
3	1	Alcohol Pad
4	1	Instructions

KIA Genuine Accessories

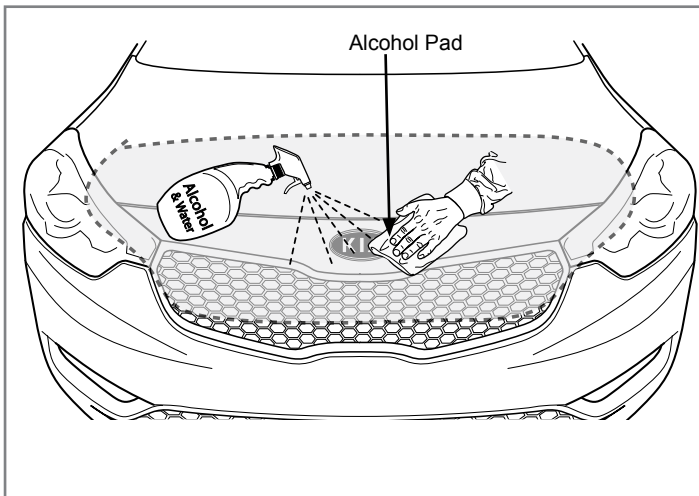

	Alcohol Prep Pad or Isopropyl Alcohol and Water Mixture in a Spray Bottle and a Microfiber Cloth	1
NOTE	Thoroughly clean the front fascia using the alcohol prep pad or isopropyl alcohol and water mixture and a microfiber cloth.	
	Make sure front fascia is completely clean and dried.	

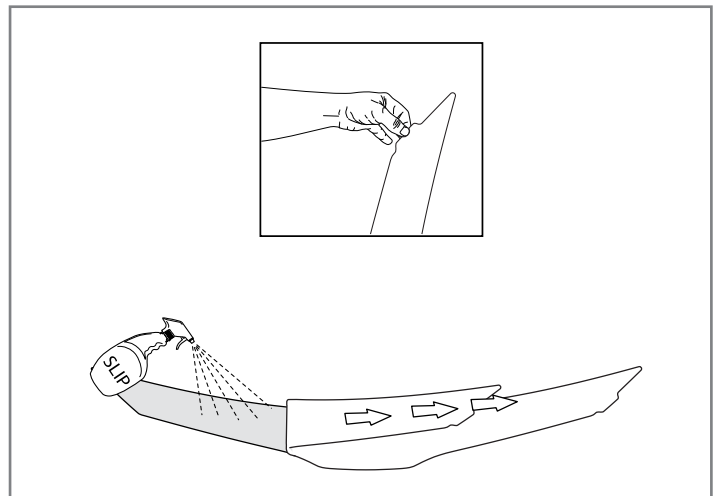

	Alcohol, Shampoo & Water Mixture (SLIP Mixture)	2
NOTE	Grasp only the Handling Tab and remove the liner from the back of the Protective Film. Spray both the Protective Film and area of installation on the front fascia with the SLIP mixture.	
	Pay special attention to not get any finger prints or dirt on the Protective Film.	

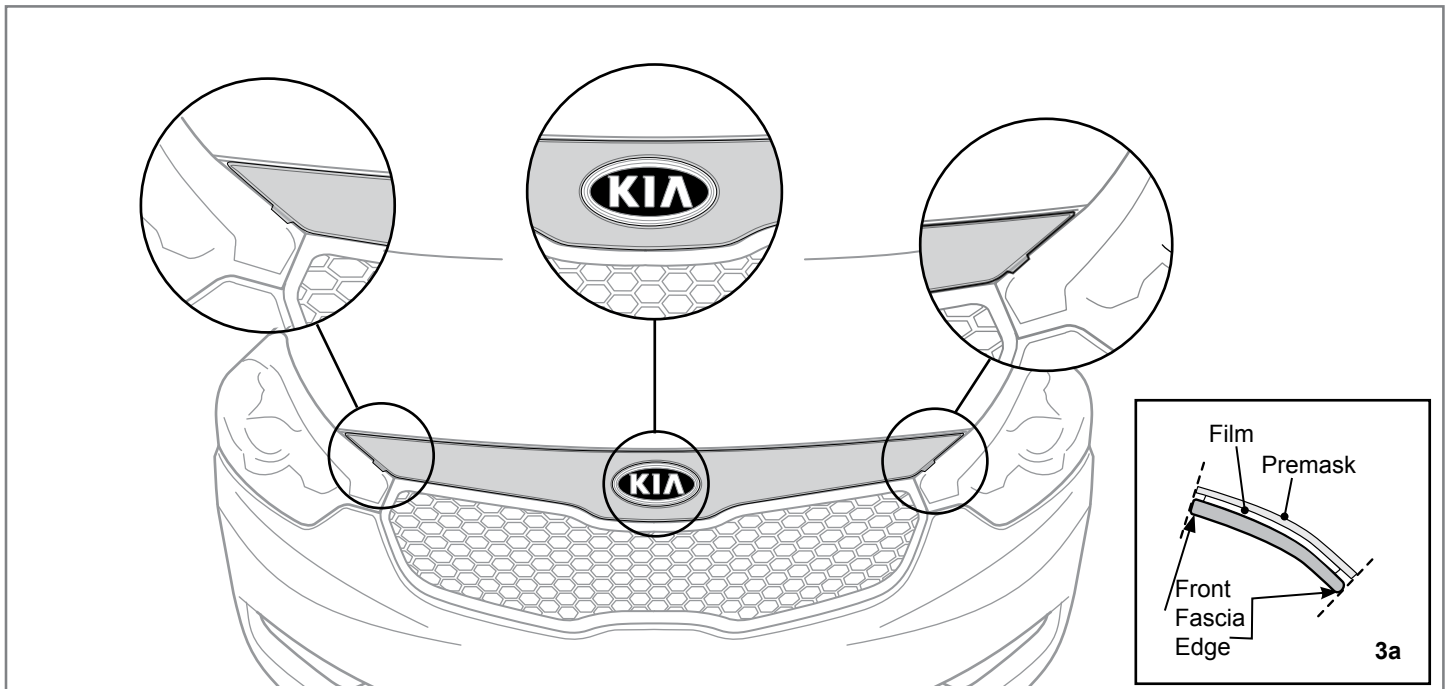

	Alcohol, Shampoo & Water Mixture (SLIP Mixture)	3
NOTE	With the vehicle still wet with the SLIP mixture, position the Protective Film onto the front fascia by visually centering the oval cut out in premask to the center of vehicle logo, as shown. The leading edge of the premask will align to the leading edge of the front fascia from corner to corner, following along the sweep of the top edge of the front fascia as shown above.	
	Note: The premask (the clear film over the protective film) must not extend beyond the front leading edge of the front fascia. The premask provides the proper set back of the film to the edge of the front fascia as noted in cross section (insert 3a). Front fascia must be wet to aid installation.	

KIA Genuine Accessories

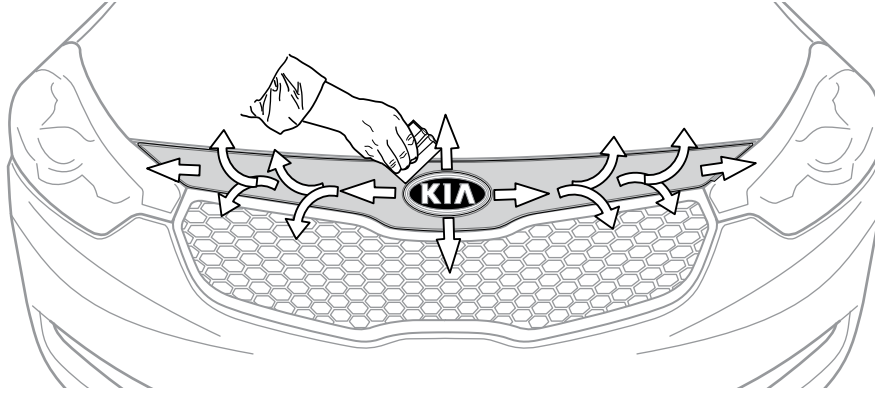

Alcohol, Shampoo & Water Mixture (SLIP Mixture) and Squeegee with Sleeve

4

NOTE

Wet pre-mask with the SLIP mixture and squeegee the Protective Film firmly onto the front fascia using overlapping squeegee strokes. Squeegee the Protective Film starting from the center around the badge bezel first, then work outwards towards the ends.



Front fascia must be wet to aid in installation. Make sure Sleeve is installed on Squeegee. Inspect for bubbles and correct following the procedure on page 4.

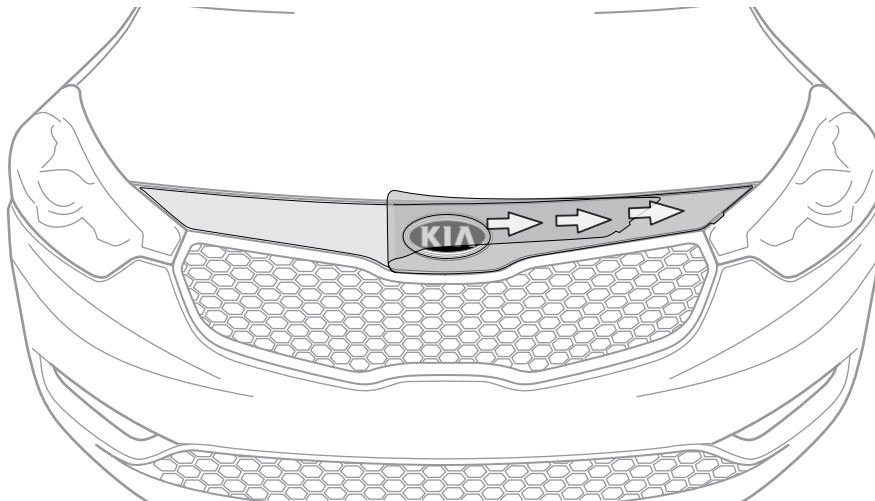

Alcohol, Shampoo & Water Mixture (SLIP Mixture), Squeegee with Sleeve and Microfiber Cloth

5



NOTE

Remove pre-mask, re-wet top of Protective Film with the SLIP mixture and re-squeegee. Dry installation area and check for proper fit. Remove and replace Protective Film if it is not properly installed.



Do not pull straight up on pre-mask during removal. Peel pre-mask at a constant 180° to ensure Protective Film placement. Inspect for bubbles and correct following the procedure on page 4. After installation, do not wash the car for 24 hours.

**KIA Genuine Accessories
Visual Check**

Items To Be Checked		Results Of The Check
	Use only the handling tabs when handling the Protective Film. Pay special attention to not get any finger prints or dirt on the Protective Film.	No dirt or finger prints on Protective Film.
	Check for bubbles. If bubbles are found, re-wet Protective Film with the soap and water mixture and using a squeegee with sleeve, push/pull/remove bubbles to the closest edge of the film.	No bubbles present.
	Make sure Protective Film is fully adhered.	Protective Film is not lifting and is fully adhered.
	Make sure Protective Film is free of any remaining premask adhesive after installation. Clean the Protective Film with soap and water if necessary.	No premask adhesive remaining on Protective Film.